

Rev.	Date	Reason	Approved
3	03/11/22	Updated carpark entrance	GS
4	01/02/23	Added signage locations	GS
5	15/02/23	Added cycle parking bay and walkway access	GS
6	21/04/23	Minor ramp amendments	GS
7	25/10/23	Accessway footpath removed, ex.piezometer to retained	GS
8	11/12/23	New alignment for accessible footpath to the beach	GS
9	16/07/24	Remove scout building and services & new carpark layout	GS
10	17/07/24	Remove pipeworks, sump, manholes, added cutout K&C	GS

## FOR INFORMATION

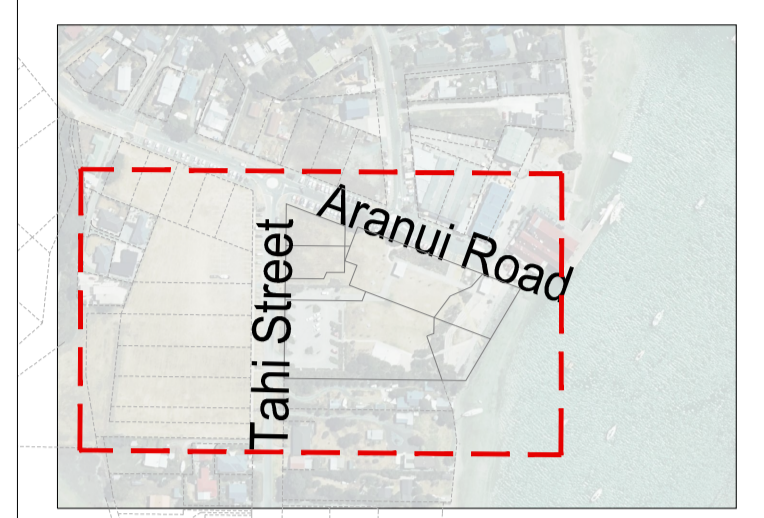

LOCATION PLAN  
Scale 1:5,000 m

### NOTES:

1. THE CONTRACTOR IS TO HAVE AN APPROVED ENVIRONMENTAL MANAGEMENT PLAN (EMP) AND A CONSTRUCTION TRAFFIC MANAGEMENT PLAN (CTMP) FROM TASMAN DISTRICT COUNCIL PRIOR TO ANY WORKS COMMENCING ONSITE.
2. ALL EARTHWORKS ARE TO BE CARRIED OUT IN ACCORDANCE WITH NZS, 4431: 2022, 'CODE OF PRACTICE FOR EARTH FILL FOR RESIDENTIAL PURPOSES', TDC SPECIFICATIONS, DAVIS OGILVIE'S SPECIFICATION, DAVIS OGILVIE'S GEOTECHNICAL INVESTIGATION FOR SUBDIVISION REPORT.
3. AT ALL TIMES CUT AND FILLS SHALL BE MAINTAINED WITH ADEQUATE FALLS AND DRAINAGE TO MINIMISE ANY INFILTRATION OF WATER AND TO ALLOW READY RUN OFF TO ENSURE NO PONDING. CONTRACTOR TO REGRADE LOT WHERE NECESSARY.
4. FILL AND SECTION LEVELS ARE MINIMUM LEVELS ONLY.
5. PRIOR TO ANY WORKS COMMENCING ONSITE, THE CONTRACTOR IS TO ENGAGE A REGISTERED PROFESSIONAL SURVEYOR AND/OR LICENSED CADASTRAL SURVEYOR TO SUPERVISE ALL SET OUT & PROVIDE ASBUILT PLANS FOR REVIEWS.
6. SETOUT IS NOT TO BE SCALED OFF THE PLANS. THE ENGINEER WILL PROVIDE ELECTRONIC DATA FOR THE CONTRACTOR. ANY VARIATIONS ARE TO BE APPROVED BY THE ENGINEER.
7. BATTERS NOT TO EXCEED A GRADE OF 1:2 UNLESS NOTED OTHERWISE. BOULDERS TO BE PLACED AS PER PLAN DETAILS.
8. ALL LEVELS ARE IN TERMS OF THE NZVD 2016 RL 2.97m. BENCHMARK IS AS PER PLAN.
9. SEA LEVEL R.L.'s ARE TAKEN AT THE PORT NELSON TIDE GAUGE. THERE MAY BE VARIATIONS BETWEEN PORT NELSON & MAPUA. A CORRECTION OF -2.578 HAS BEEN APPLIED TO CONVERT PORT NELSON LEVELS TO NZVD2016 LEVELS.
10. EXISTING SERVICE LOCATION AND PROTECTION IS CONTRACTOR'S RESPONSIBILITY. EXISTING SERVICES SHOWN ON PLANS ARE INDICATIVE ONLY. REFER TO PROVIDERS' AS-BUILT PLANS AND UNDERTAKE UNDERGROUND CABLE LOCATION AND POT HOLING AS REQUIRED.
11. ALL LANDSCAPING WORK SHALL BE CARRIED OUT IN ACCORDANCE WITH THE LANDSCAPE ARCHITECTS DRAWINGS, AND THE TASMAN DISTRICT COUNCILS SPECIFICATIONS

KEY	
KERB LEVELS	K 3.75
SURFACE LEVEL	SL 3.76
EXISTING SEWER	---
PROPOSED SEWER	---
EXISTING WATER	---
PROPOSED WATER	---
EXISTING STORMWATER	---
PROPOSED STORMWATER	---
PROPOSED BATTER LINE	---
SECTION FORMATION LEVELS	FL 4.85
EXISTING GROUND CONTOURS	---
METAL SURFACE FORMATION	---
CONCRETE RAMP FORMATION	---
GARDEN AREA	---
PIEZOMETER TEST LOCATION	---
TOPO PICK UP LOCATION OF EXISTING SEWER	---
S1-S9 SIGNAGE LOCATIONS	---

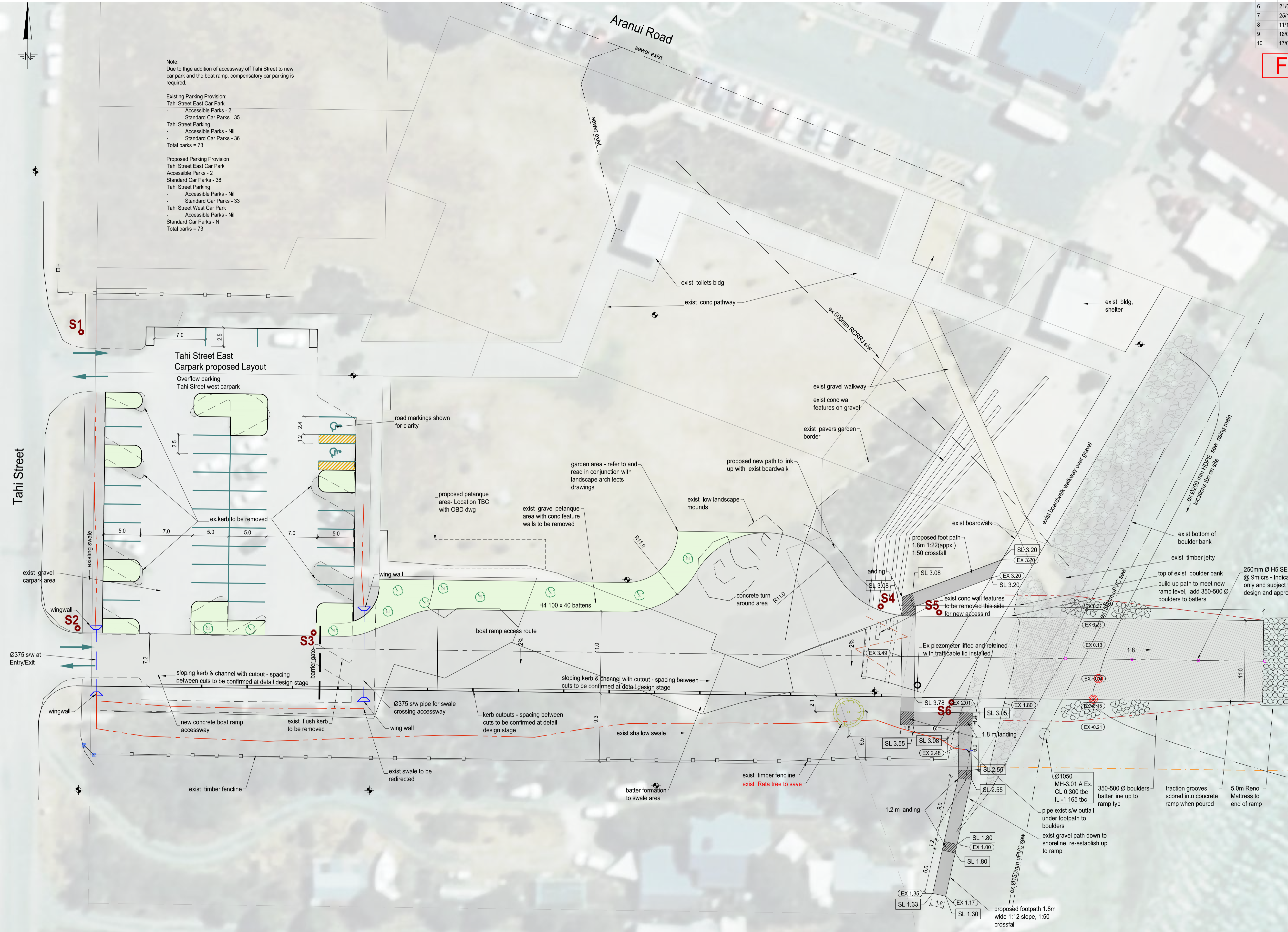

CAD ref. 42454.Master Xref

**do DAVIS OGILVIE**  
 ENGINEERS / SURVEYORS / PLANNERS

Davis Ogilvie & Partners Limited  
 Level 1, 24 Moorhouse Avenue, Addington, Christchurch 8140  
 Office 0800 999 333 Email hello@do.nz  
 www.do.nz

## PROPOSED MAPUA BOAT RAMP NELSON - MAPUA COMMUNITY BOAT RAMP TRUST

## ENGINEERING DESIGN PRELIM ACCESS ROAD & RAMP LAYOUT

Design	Drawn	QA Check	Dwg No.
BSL	BSL	GS	Prelim P1
Scale @ A1	Date	Job No.	Rev.
1:250 (m)	1 07/2022	42454	10



Rev.	Date	Reason	Approved
1	04/08/2022	Issued for discussion	GS
2	16/08/2022	Prelim Issue, landscape overlay on plan	GS
3	21/04/2023	Minor ramp amendments	GS
4	26/04/2023	Minor changes	GS

**FOR INFORMATION**

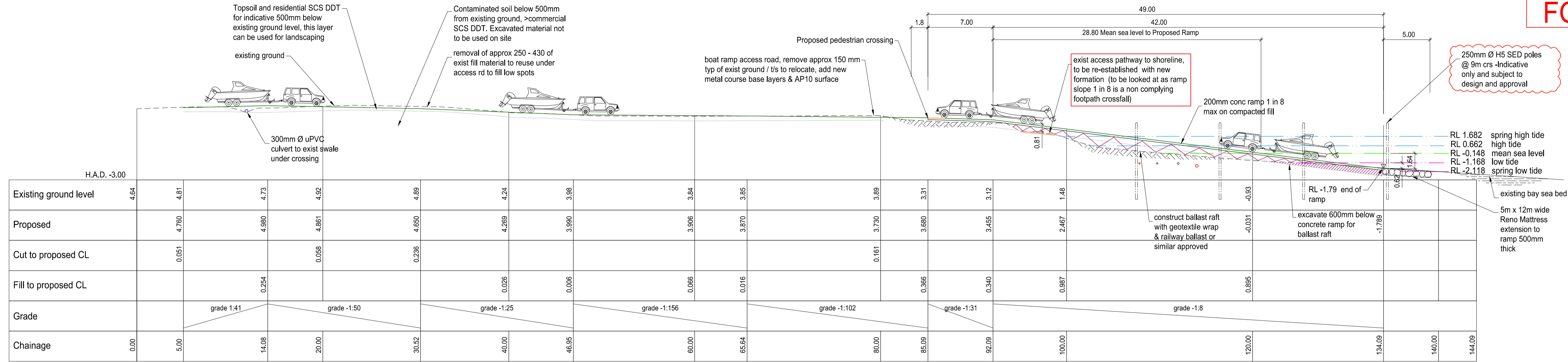

**Road Access Longsection**

Scale: Horiz 1:250  
Vert 1:250

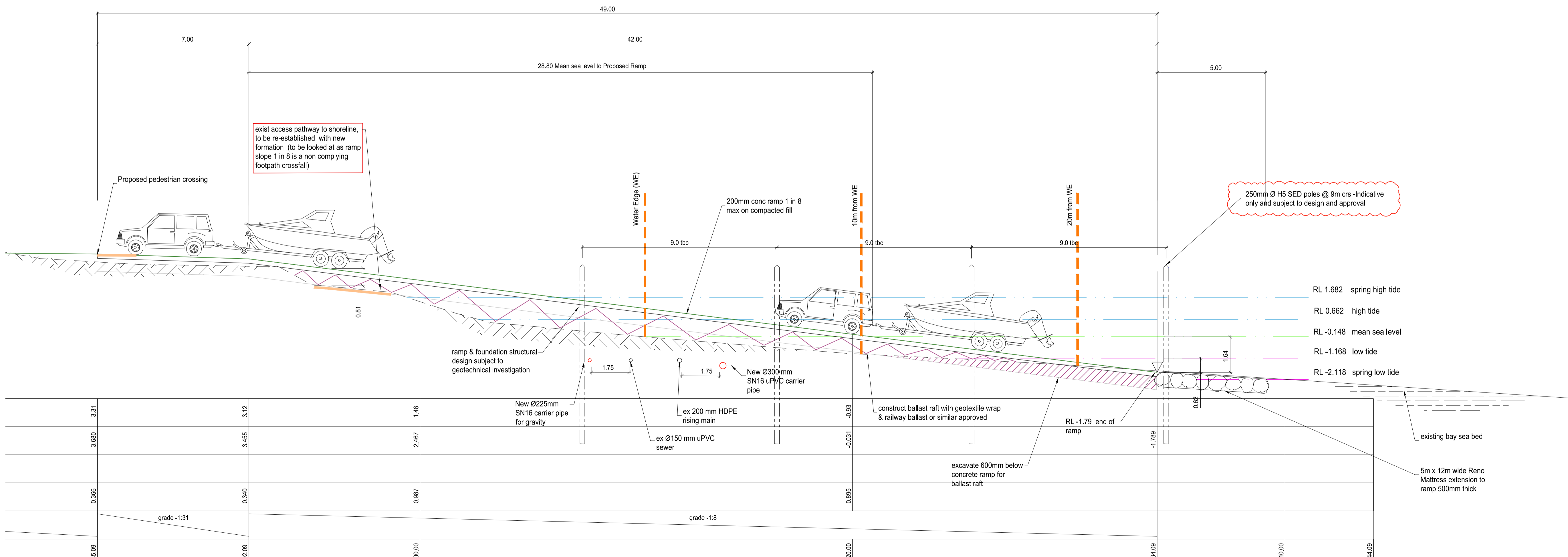

CAD ref: 42454.Master Xref



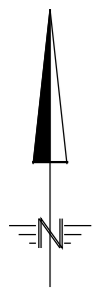

Rev.	Date	Reason	Approved
P1	08/11/22	Issued for discussion	GS
P2	21/12/22	Minor change to carpark	GS
P3	13/11/23	Changes to boat and trailer park, New bund	GS
P4	17/07/24	Carpark and bund removed	GS

**FOR INFORMATION**



Note:  
Due to the addition of accessway off Tahsi Street car park and the boat ramp, compensatory car required.

Existing Parking Provision:  
Tahsi Street East Car Park  
- Accessible Parks - 2  
- Standard Car Parks - 35  
Tahsi Street Parking  
- Accessible Parks - Nil  
- Standard Car Parks - 36  
Total parks = 73

Proposed Parking Provision  
Tahsi Street East Car Park  
Accessible Parks - 2  
Standard Car Parks - 38  
Tahsi Street Parking  
- Accessible Parks - Nil  
- Standard Car Parks - 33  
Tahsi Street West Car Park  
- Accessible Parks - Nil  
Standard Car Parks - Nil  
Total parks = 73



Rev.	Date	Reason	Approved
1	08/11/22	Issued for discussion	GS
2	21/12/22	Minor change to carpark	
3	01/02/23	Added signage locations	GS
4	15/02/23	Added cycle parking bay and walkway access	GS
5	14/04/23	Added speed bump behind footpath	GS
6	10/11/23	Permanant bund around west carpark	GS
7	17/07/24	Carpark and bund removed	GS

**FOR INFORMATION**

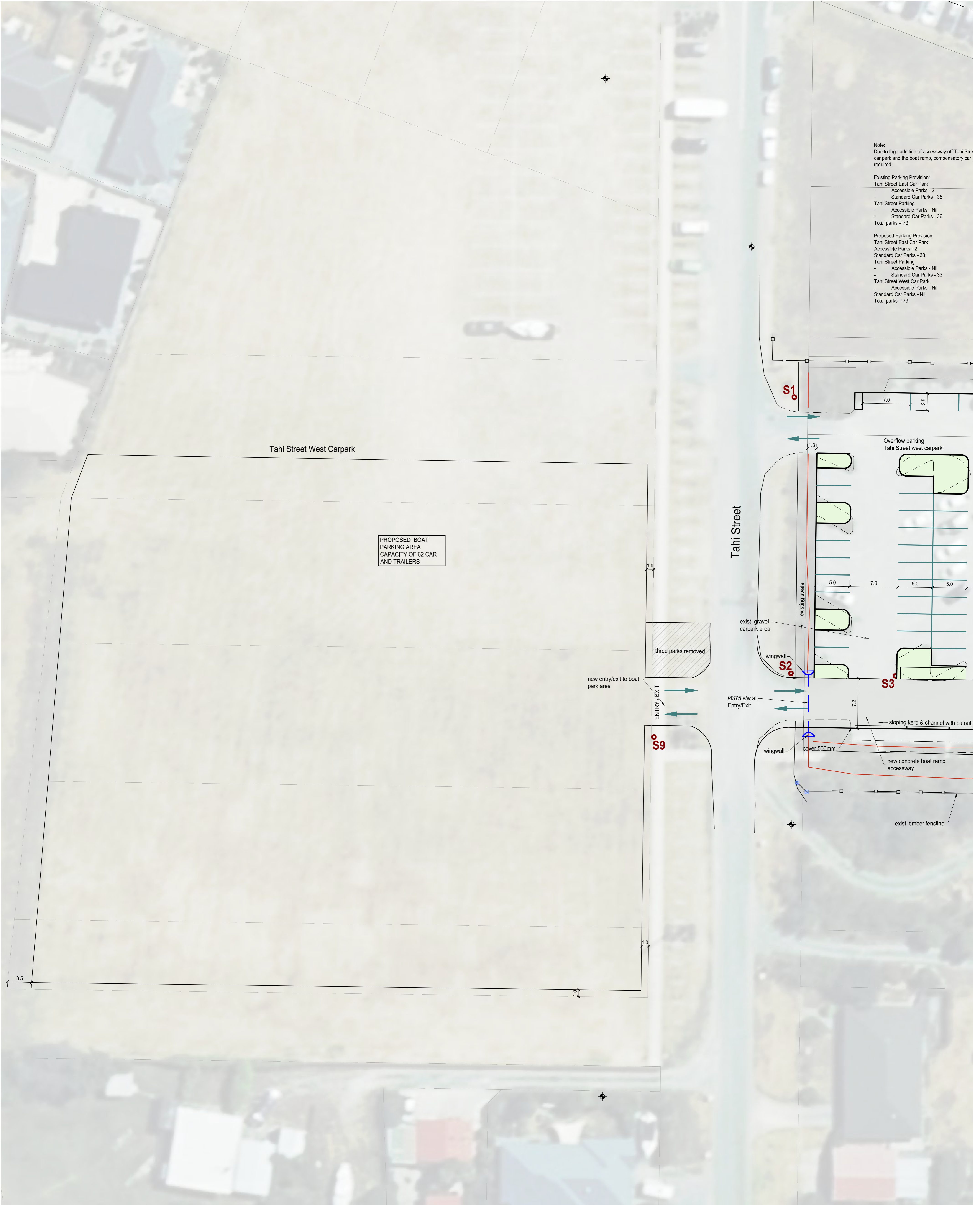

Note:  
Due to the addition of accessway off Tahiti Street car park and the boat ramp, compensatory car required.

Existing Parking Provision:  
Tahiti Street East Car Park  
- Accessible Parks - 2  
- Standard Car Parks - 35  
Tahiti Street Parking  
- Accessible Parks - Nil  
- Standard Car Parks - 36  
Total parks = 73

Proposed Parking Provision  
Tahiti Street East Car Park  
Accessible Parks - 2  
Standard Car Parks - 38  
Tahiti Street Parking  
- Accessible Parks - Nil  
- Standard Car Parks - 33  
Tahiti Street West Car Park  
- Accessible Parks - Nil  
Standard Car Parks - Nil  
Total parks = 73



Rev.	Date	Reason	Approved
1	25/01/2023	Issued for discussion	GS
2	13/12/2023	Additional detail - footpath cross-section	GS
3	17/07/2024	Scout building carpark detail- removed	GS
4	17/07/2024	Additional detail- kerb cutout	GS

**FOR INFORMATION**

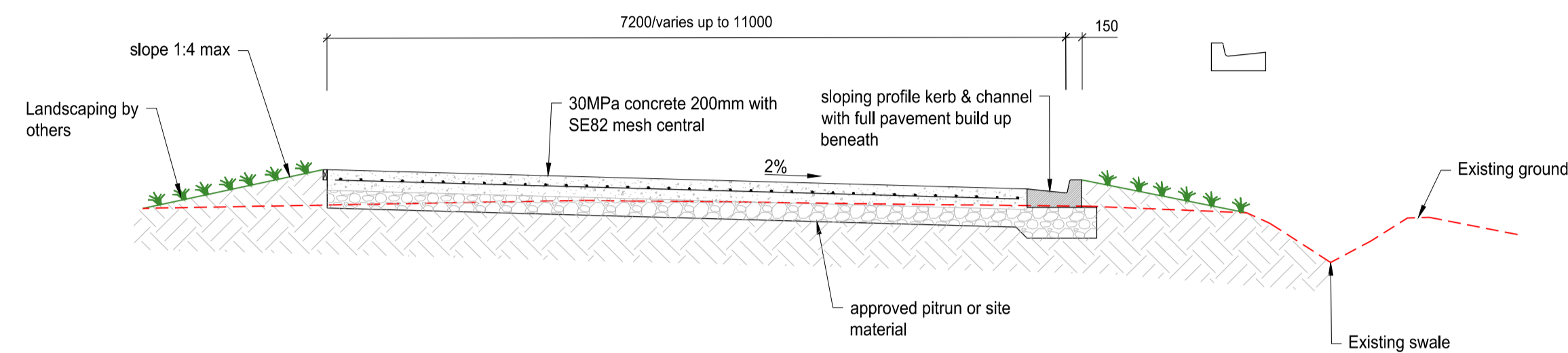

**TYPICAL CROSS SECTION CONCRETE RAMP ACCESSWAY AT ENTRANCE**  
Scale: 1:50

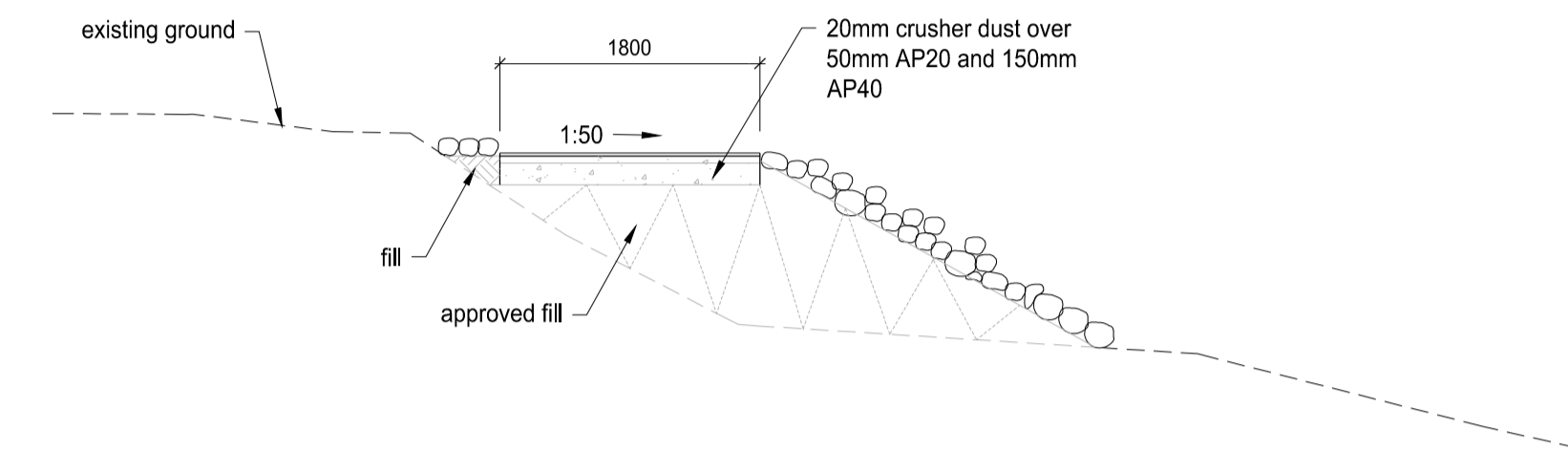

**NEW FOOTPATH TYPICAL CROSS-SECTION**  
Scale: 1:50

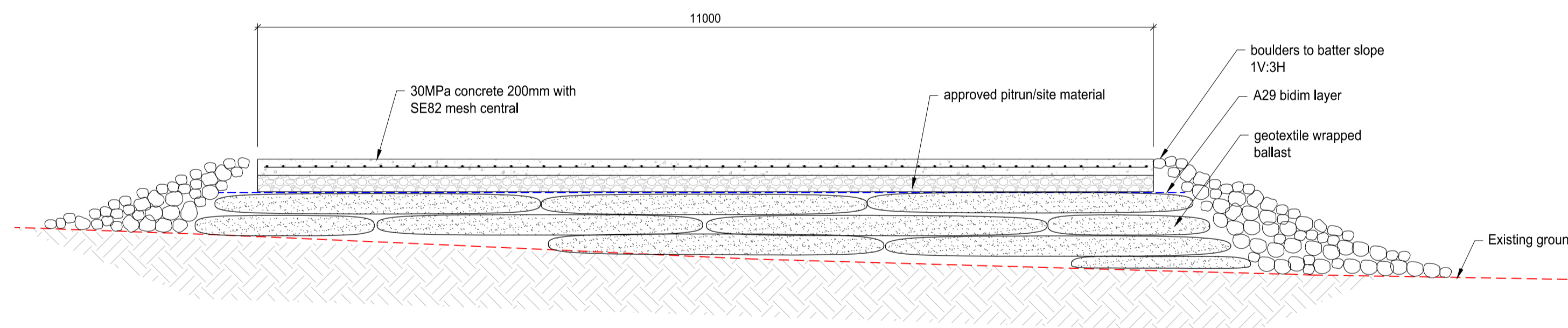

**TYPICAL CROSS SECTION CONCRETE RAMP ACCESSWAY**  
Scale: 1:50

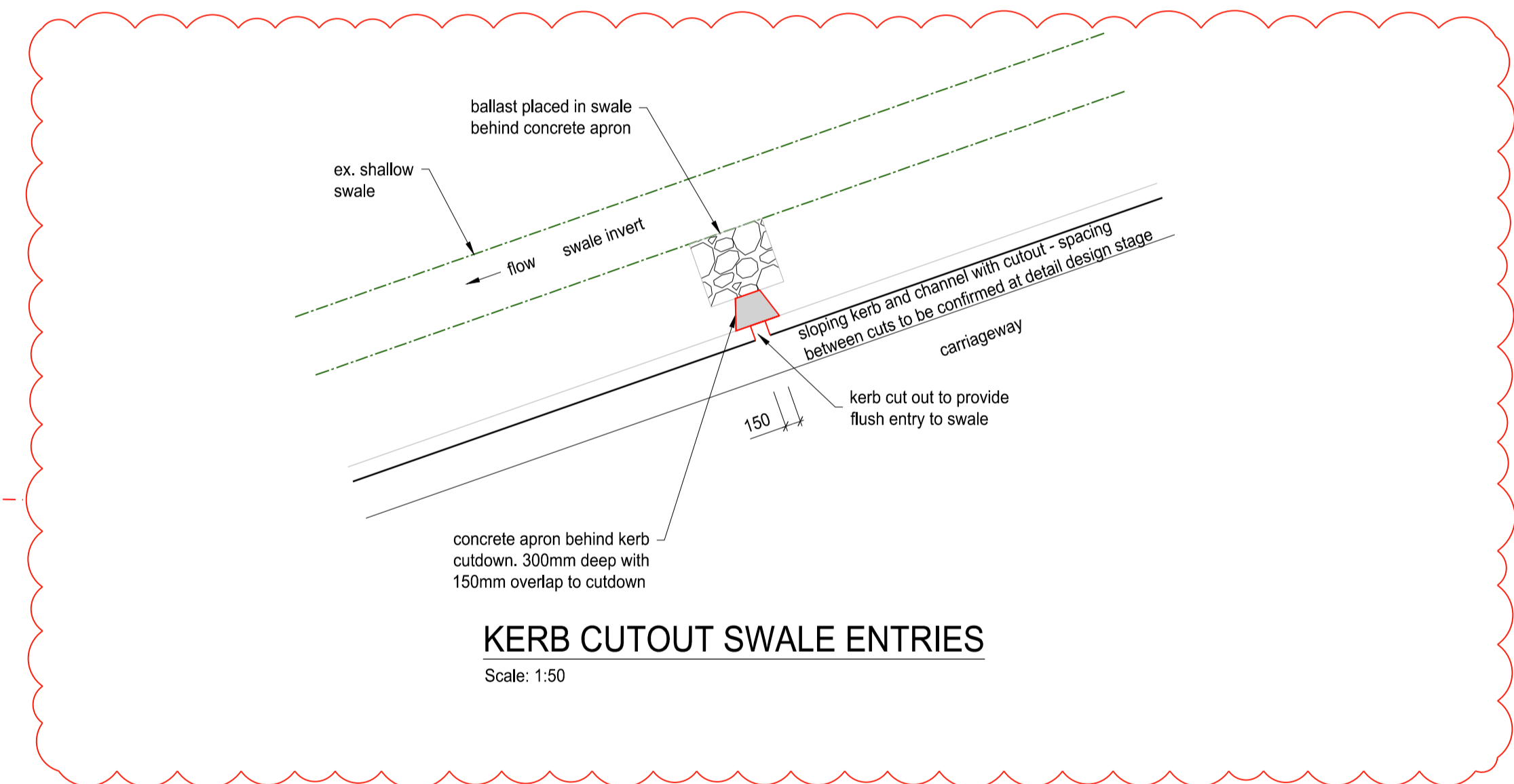

**KERB CUTOUT SWALE ENTRIES**  
Scale: 1:50