

**RECORD OF TITLE  
UNDER LAND TRANSFER ACT 2017  
FREEHOLD  
Search Copy**



R.W. Muir  
Registrar-General  
of Land

**Identifier** **NL13A/1079**  
**Land Registration District** **Nelson**  
**Date Issued** 01 November 2000

**Prior References**

NL9B/1023                      NL9B/1024

---

**Estate**                      Fee Simple  
**Area**                        9991 square metres more or less  
**Legal Description**    Lot 1 Deposited Plan 19736 and Lot 1  
   Deposited Plan 20392

**Registered Owners**

Network Tasman Limited

**Interests**

Subject to Section 241 (2) Resource Management Act 1991 (Affects DP 19736)

169237.1 Gazette Notice declaring the adjoining road a limited access road - 11.12.1975 at 1.57 pm

402082.3 Transfer creating the following easements - 1.11.2000 at 2.59 pm

Type	Servient Tenement	Easement Area	Dominant Tenement	Statutory Restriction
Convey water	Lot 2 Deposited Plan 20392 - CT NL13A/1080	E-F DP 19736	Lot 1 Deposited Plan 20392 - herein	
Right of way	Lot 2 Deposited Plan 19736 - CT NL13A/1080	A DP 19736	Lot 1 Deposited Plan 19736 and Lot 1 Deposited Plan 20392 - herein	
Right of way	Lot 2 Deposited Plan 20392 - CT NL13A/1080	B & C DP 19736	Lot 1 Deposited Plan 19736 and Lot 1 Deposited Plan 20392 - herein	
Right of way	Lot 1 Deposited Plan 20392 - herein	D DP 19736	Lot 2 Deposited Plan 20392 and Lot 2 Deposited Plan 19736 - CT NL13A/1080	

The easements granted by Transfer 402082.3 are subject to Section 243(a) Resource Management Act 1991

5231044.1 Notice pursuant to Section 91 Transit New Zealand Act 1989 - 27.5.2002 at 9:00 am

Appurtenant to Lot 1 DP 20392 is a right to convey electricity, telecommunications and computer media created by Easement Instrument 8681073.1 - 7.2.2011 at 1:57 pm

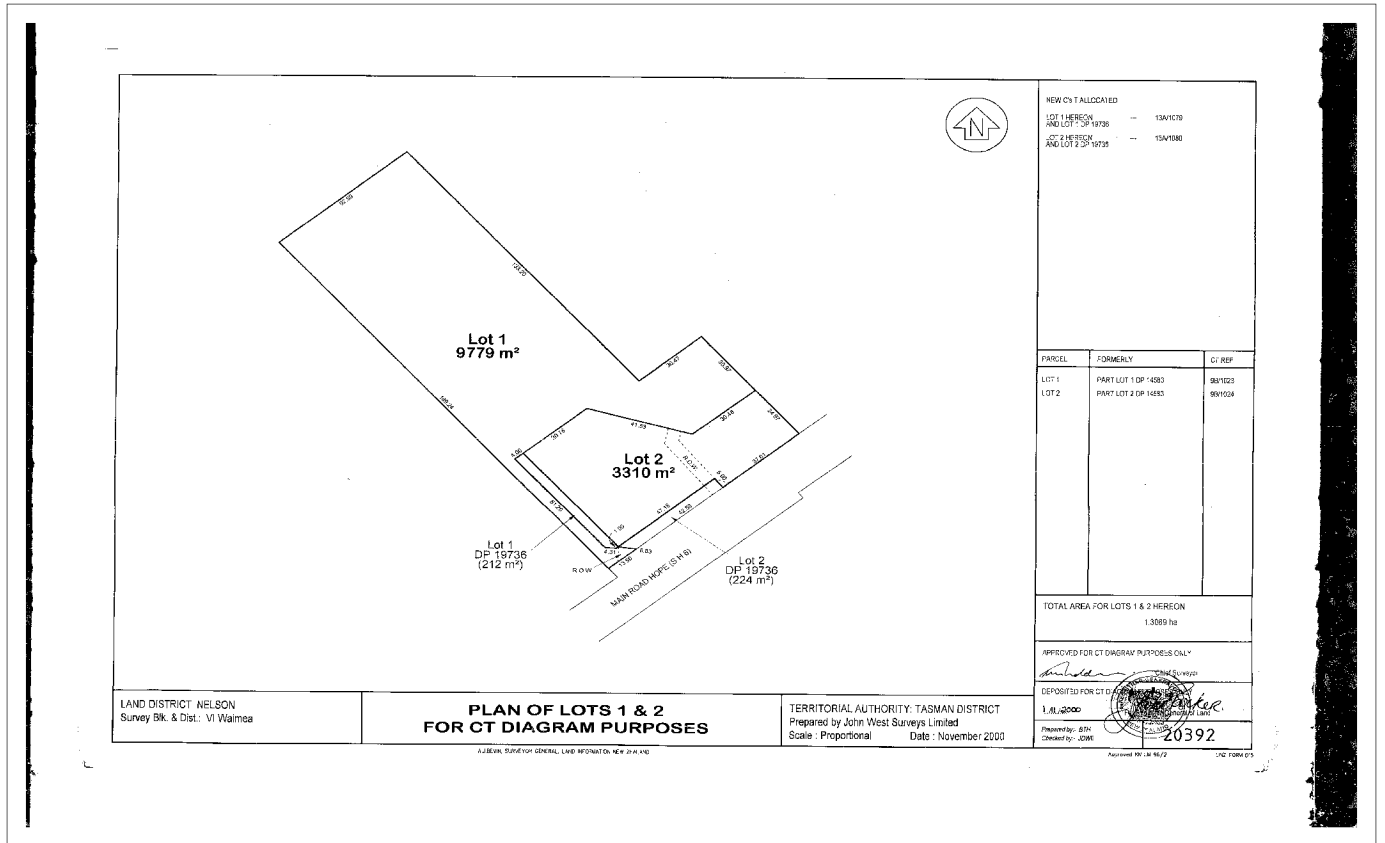

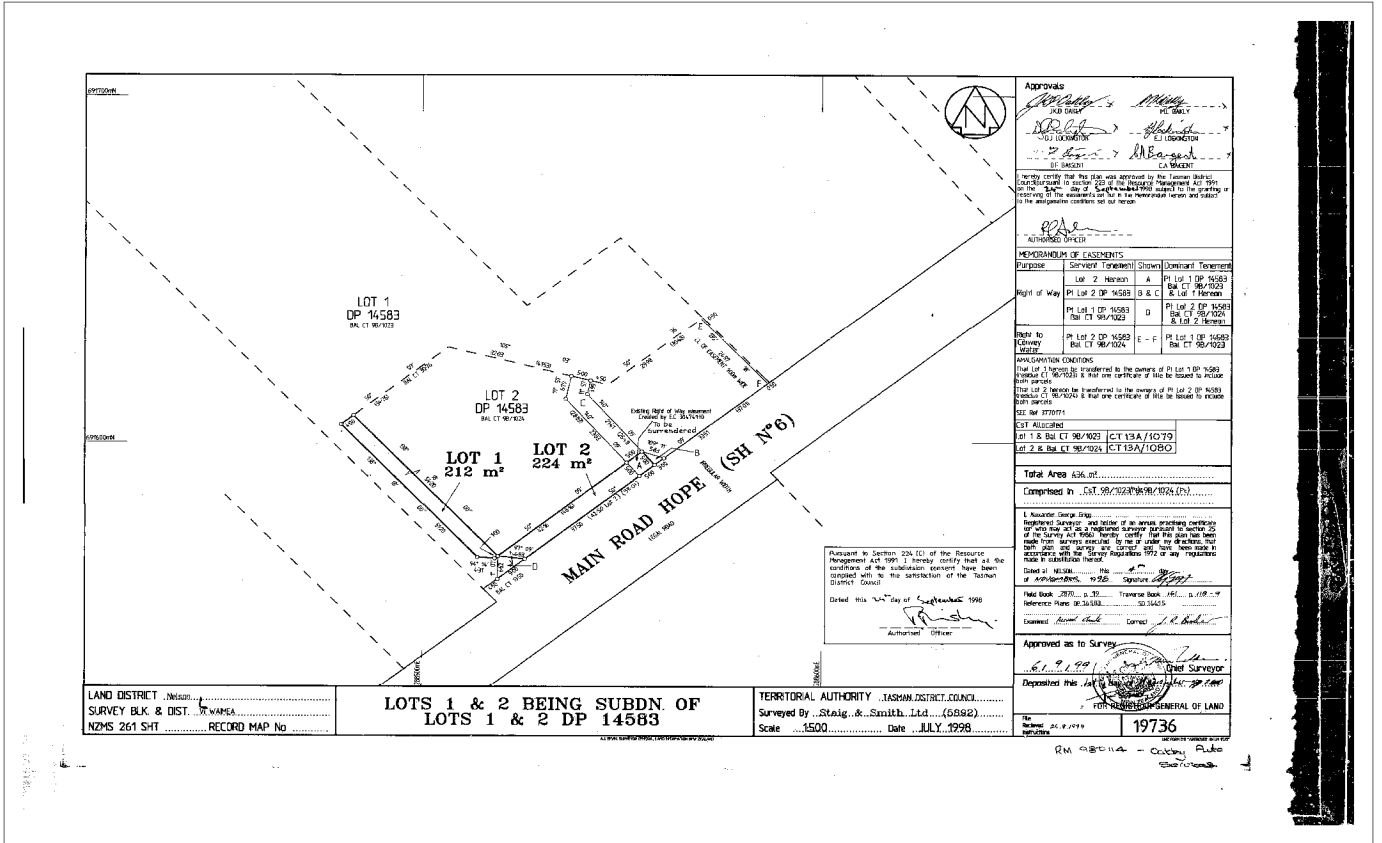

**Approve**  
*[Signature]*  
 M. J. O'NEILL  
 M. J. O'NEILL  
 M. J. O'NEILL  
 M. J. O'NEILL  
 M. J. O'NEILL

I hereby certify that this plan was approved by the Town Clerk of the District of Southland 1998 for the purposes of the Land Act 1948 and that the same is in accordance with the provisions of the Land Act 1948 and that the same is in accordance with the provisions of the Land Act 1948 and that the same is in accordance with the provisions of the Land Act 1948.

**MEMORANDUM OF EASEMENTS**

Purpose	Survey	Township	Shown	Dominant Tenement
Right of Way	Lot 2 DP 14583	B & C		Lot 1 DP 14583
	Lot 1 DP 14583	D		Lot 2 DP 14583
	Lot 2 DP 14583	E & F		Lot 1 DP 14583

**APPROVAL CONDITIONS**  
 That Lot 1, 2, 3, 4, 5, 6, 7, 8, 9, 10, 11, 12, 13, 14, 15, 16, 17, 18, 19, 20, 21, 22, 23, 24, 25, 26, 27, 28, 29, 30, 31, 32, 33, 34, 35, 36, 37, 38, 39, 40, 41, 42, 43, 44, 45, 46, 47, 48, 49, 50, 51, 52, 53, 54, 55, 56, 57, 58, 59, 60, 61, 62, 63, 64, 65, 66, 67, 68, 69, 70, 71, 72, 73, 74, 75, 76, 77, 78, 79, 80, 81, 82, 83, 84, 85, 86, 87, 88, 89, 90, 91, 92, 93, 94, 95, 96, 97, 98, 99, 100, 101, 102, 103, 104, 105, 106, 107, 108, 109, 110, 111, 112, 113, 114, 115, 116, 117, 118, 119, 120, 121, 122, 123, 124, 125, 126, 127, 128, 129, 130, 131, 132, 133, 134, 135, 136, 137, 138, 139, 140, 141, 142, 143, 144, 145, 146, 147, 148, 149, 150, 151, 152, 153, 154, 155, 156, 157, 158, 159, 160, 161, 162, 163, 164, 165, 166, 167, 168, 169, 170, 171, 172, 173, 174, 175, 176, 177, 178, 179, 180, 181, 182, 183, 184, 185, 186, 187, 188, 189, 190, 191, 192, 193, 194, 195, 196, 197, 198, 199, 200, 201, 202, 203, 204, 205, 206, 207, 208, 209, 210, 211, 212, 213, 214, 215, 216, 217, 218, 219, 220, 221, 222, 223, 224, 225, 226, 227, 228, 229, 230, 231, 232, 233, 234, 235, 236, 237, 238, 239, 240, 241, 242, 243, 244, 245, 246, 247, 248, 249, 250, 251, 252, 253, 254, 255, 256, 257, 258, 259, 260, 261, 262, 263, 264, 265, 266, 267, 268, 269, 270, 271, 272, 273, 274, 275, 276, 277, 278, 279, 280, 281, 282, 283, 284, 285, 286, 287, 288, 289, 290, 291, 292, 293, 294, 295, 296, 297, 298, 299, 300, 301, 302, 303, 304, 305, 306, 307, 308, 309, 310, 311, 312, 313, 314, 315, 316, 317, 318, 319, 320, 321, 322, 323, 324, 325, 326, 327, 328, 329, 330, 331, 332, 333, 334, 335, 336, 337, 338, 339, 340, 341, 342, 343, 344, 345, 346, 347, 348, 349, 350, 351, 352, 353, 354, 355, 356, 357, 358, 359, 360, 361, 362, 363, 364, 365, 366, 367, 368, 369, 370, 371, 372, 373, 374, 375, 376, 377, 378, 379, 380, 381, 382, 383, 384, 385, 386, 387, 388, 389, 390, 391, 392, 393, 394, 395, 396, 397, 398, 399, 400, 401, 402, 403, 404, 405, 406, 407, 408, 409, 410, 411, 412, 413, 414, 415, 416, 417, 418, 419, 420, 421, 422, 423, 424, 425, 426, 427, 428, 429, 430, 431, 432, 433, 434, 435, 436, 437, 438, 439, 440, 441, 442, 443, 444, 445, 446, 447, 448, 449, 450, 451, 452, 453, 454, 455, 456, 457, 458, 459, 460, 461, 462, 463, 464, 465, 466, 467, 468, 469, 470, 471, 472, 473, 474, 475, 476, 477, 478, 479, 480, 481, 482, 483, 484, 485, 486, 487, 488, 489, 490, 491, 492, 493, 494, 495, 496, 497, 498, 499, 500, 501, 502, 503, 504, 505, 506, 507, 508, 509, 510, 511, 512, 513, 514, 515, 516, 517, 518, 519, 520, 521, 522, 523, 524, 525, 526, 527, 528, 529, 530, 531, 532, 533, 534, 535, 536, 537, 538, 539, 540, 541, 542, 543, 544, 545, 546, 547, 548, 549, 550, 551, 552, 553, 554, 555, 556, 557, 558, 559, 560, 561, 562, 563, 564, 565, 566, 567, 568, 569, 570, 571, 572, 573, 574, 575, 576, 577, 578, 579, 580, 581, 582, 583, 584, 585, 586, 587, 588, 589, 590, 591, 592, 593, 594, 595, 596, 597, 598, 599, 600, 601, 602, 603, 604, 605, 606, 607, 608, 609, 610, 611, 612, 613, 614, 615, 616, 617, 618, 619, 620, 621, 622, 623, 624, 625, 626, 627, 628, 629, 630, 631, 632, 633, 634, 635, 636, 637, 638, 639, 640, 641, 642, 643, 644, 645, 646, 647, 648, 649, 650, 651, 652, 653, 654, 655, 656, 657, 658, 659, 660, 661, 662, 663, 664, 665, 666, 667, 668, 669, 670, 671, 672, 673, 674, 675, 676, 677, 678, 679, 680, 681, 682, 683, 684, 685, 686, 687, 688, 689, 690, 691, 692, 693, 694, 695, 696, 697, 698, 699, 700, 701, 702, 703, 704, 705, 706, 707, 708, 709, 710, 711, 712, 713, 714, 715, 716, 717, 718, 719, 720, 721, 722, 723, 724, 725, 726, 727, 728, 729, 730, 731, 732, 733, 734, 735, 736, 737, 738, 739, 740, 741, 742, 743, 744, 745, 746, 747, 748, 749, 750, 751, 752, 753, 754, 755, 756, 757, 758, 759, 760, 761, 762, 763, 764, 765, 766, 767, 768, 769, 770, 771, 772, 773, 774, 775, 776, 777, 778, 779, 780, 781, 782, 783, 784, 785, 786, 787, 788, 789, 790, 791, 792, 793, 794, 795, 796, 797, 798, 799, 800, 801, 802, 803, 804, 805, 806, 807, 808, 809, 810, 811, 812, 813, 814, 815, 816, 817, 818, 819, 820, 821, 822, 823, 824, 825, 826, 827, 828, 829, 830, 831, 832, 833, 834, 835, 836, 837, 838, 839, 840, 841, 842, 843, 844, 845, 846, 847, 848, 849, 850, 851, 852, 853, 854, 855, 856, 857, 858, 859, 860, 861, 862, 863, 864, 865, 866, 867, 868, 869, 870, 871, 872, 873, 874, 875, 876, 877, 878, 879, 880, 881, 882, 883, 884, 885, 886, 887, 888, 889, 890, 891, 892, 893, 894, 895, 896, 897, 898, 899, 900, 901, 902, 903, 904, 905, 906, 907, 908, 909, 910, 911, 912, 913, 914, 915, 916, 917, 918, 919, 920, 921, 922, 923, 924, 925, 926, 927, 928, 929, 930, 931, 932, 933, 934, 935, 936, 937, 938, 939, 940, 941, 942, 943, 944, 945, 946, 947, 948, 949, 950, 951, 952, 953, 954, 955, 956, 957, 958, 959, 960, 961, 962, 963, 964, 965, 966, 967, 968, 969, 970, 971, 972, 973, 974, 975, 976, 977, 978, 979, 980, 981, 982, 983, 984, 985, 986, 987, 988, 989, 990, 991, 992, 993, 994, 995, 996, 997, 998, 999, 1000.

**Approved as to Survey**  
*[Signature]*  
 Chief Surveyor

Deposited this 14th day of July 1998  
 FOR THE REGISTER GENERAL OF LAND

19736

RM 98014 - Copying Rules

LAND DISTRICT Nelson  
 SURVEY BLK & DIST. 7 WAKA  
 NZMS 261 SH1 RECORD MAP No

**LOTS 1 & 2 BEING SUBDN. OF LOTS 1 & 2 DP 14583**

TERRITORIAL AUTHORITY TASHAM DISTRICT IDAUC  
 Surveyed By Staig & Smith Ltd (5582)  
 Scale 1:500 Date JULY 1998